

# AC 30937 — CROSSOVER

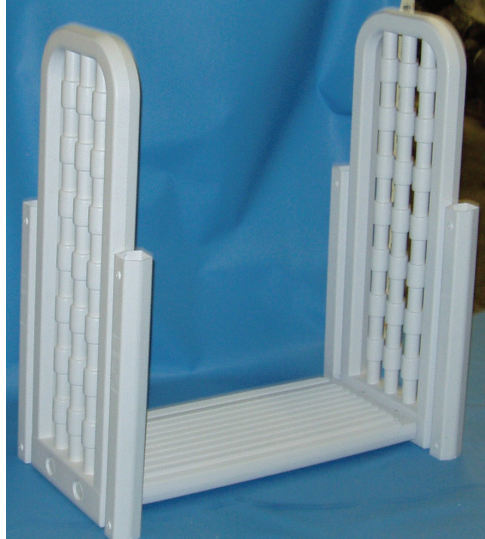

**CROSSOVER FOR USE WITH:**



**TAHITIAN BRIDGE SYSTEM**  
(Without Gate) BS BRIDGE



**PARADISE ISLE BRIDGE SYSTEM**  
(With Gate) BS ENCLOSEB

## TOOLS REQUIRED

- Hammer and a wood block or rubber mallet
- Phillips head screwdriver
- Drill with 1/8" drill bit
- Pliers • Liquid soap or lubricant

This crossover is intended for use with both the **Tahitian** and **Paradise Isle Bridge Systems**. Please start by assembling BOTH steps using instructions provided in the STEP BOX, model **AC 30163**. Refer to these directions once you have assembled both steps.

If you are installing the Paradise Isle Bridge System, please check the carton labeled "GATE CARTON" model **AC 30988** for instructions on gate assembly and attachment, upon completion of installation of crossover.

# PARTS & HARDWARE FOR CROSSOVER

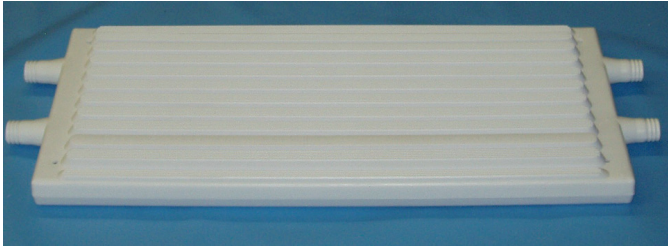

**A. CONNECTING STEP**  
(AC CONSTEP)

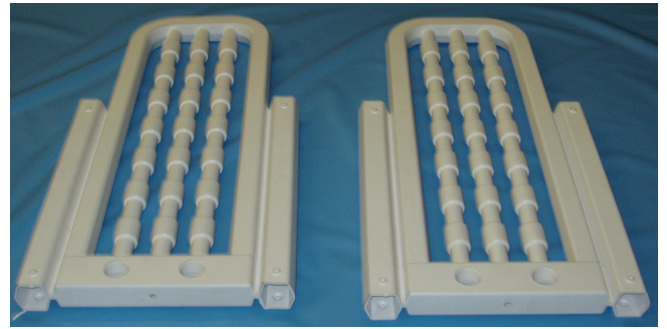

**B. CONNECTING RAILS (2)**  
(AC CONRAIL)



**C. SINGLE PICKETS (2)**  
(AC PICKETS1)

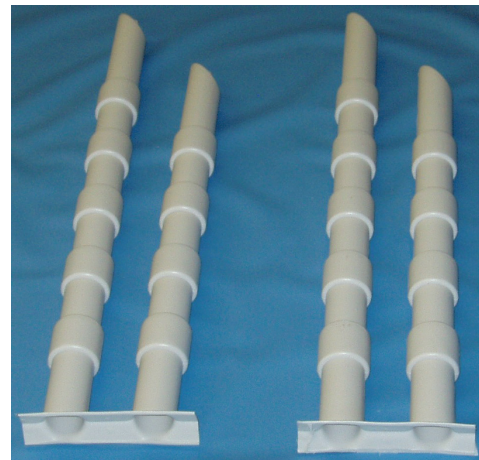

**D. DOUBLE PICKETS (5)**  
(AC PICKETS2)

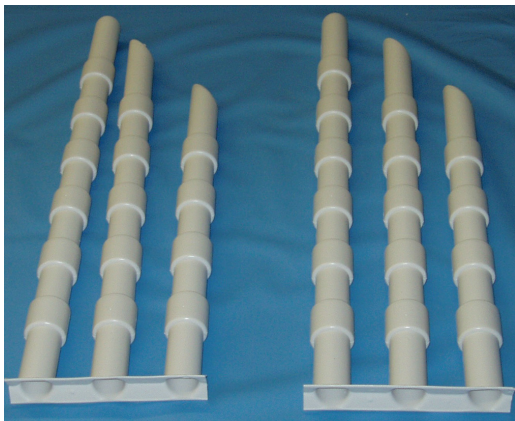

**E. TRIPLE PICKETS (2)**  
(AC PICKETS3)

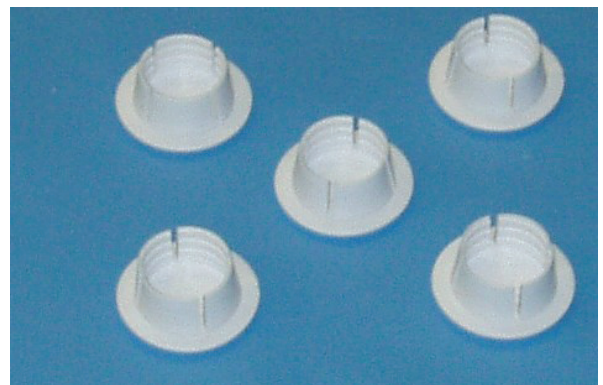

**F. LOCK CAPS (5)**  
(AC LOCKCAP)

## HARDWARE

(AC HDW30937)

**G.** (40) #10 x 1-1/4" Screw

**H.** (12) #10 x 3/4" Screw

# CROSSOVER PARTS

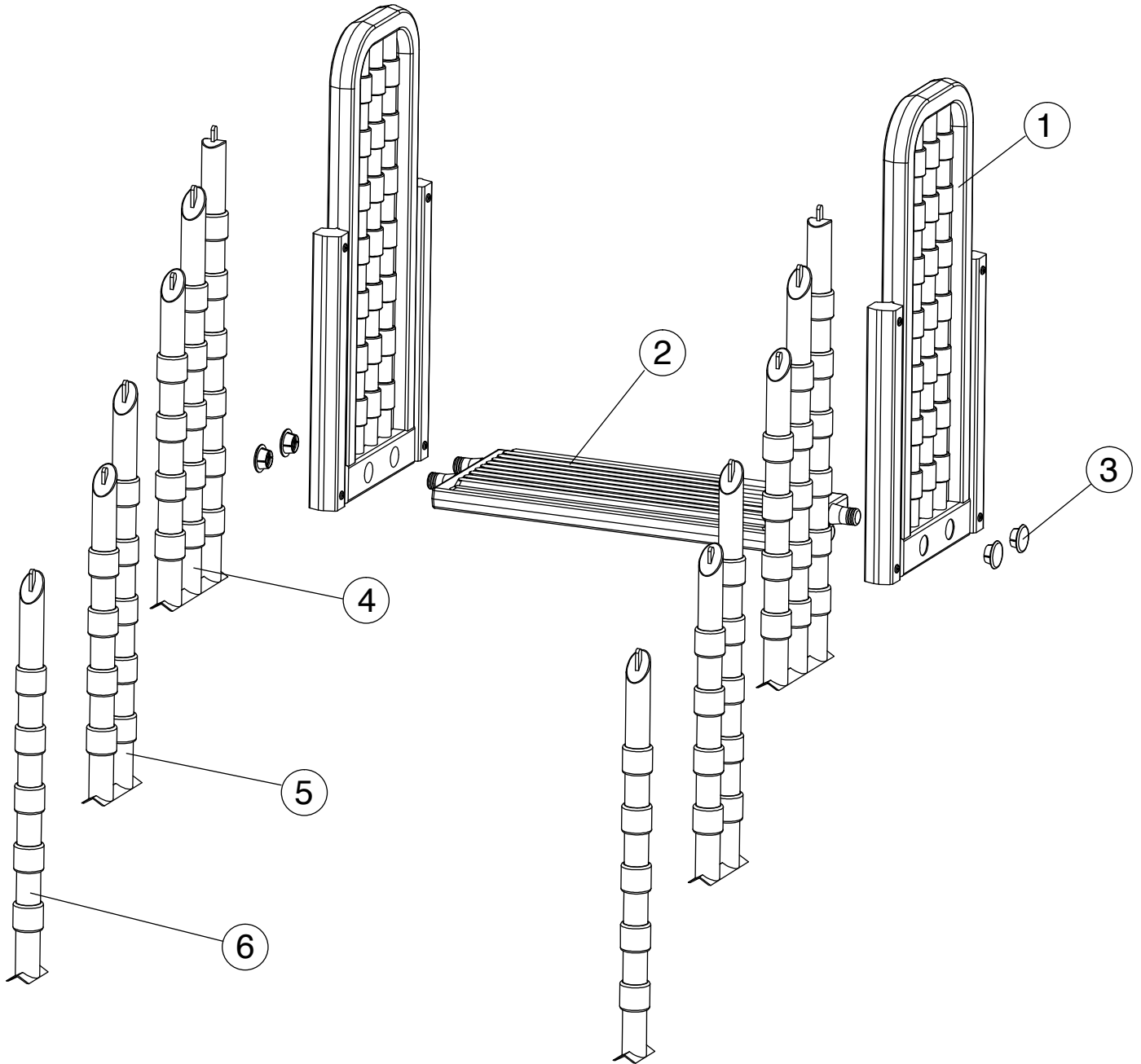

PART #	MODEL #	DESCRIPTION	QTY
1	AC CONRAIL	Connect Rail	1
2	AC CONSTEP	Connect Step	1
3	AC LOCKCAP	Lock Cap	4
4	AC PICKETS3	Picket 3	2
5	AC PICKETS2	Picket 2	2
6	AC PICKETS1	Picket Single	2

## STEP 1

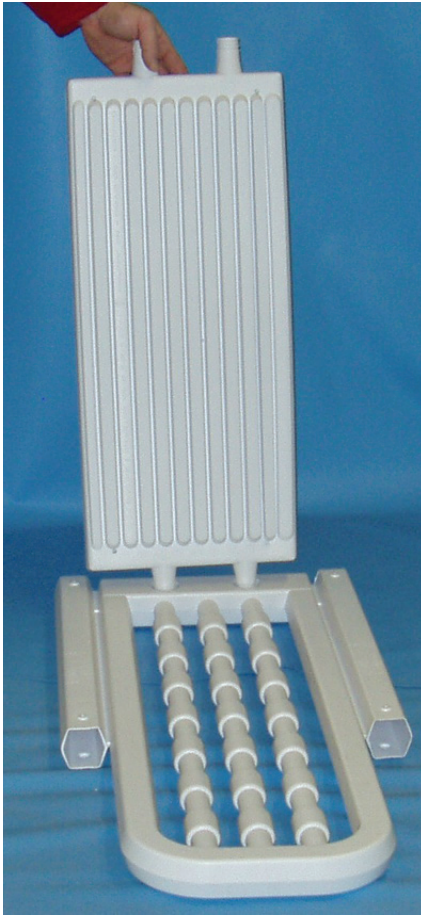

Lay one of the connecting rails **(B)** down on a clean, flat surface. Make sure the tread surface of the connecting step **(A)** is facing up towards the rails. Push the end of the connecting step into the openings of the connecting rail until fully seated.

## STEP 2

Lay the second connecting rail **(B)** down and push the opposite end of the connecting step **(A)** into the openings until fully seated.



## STEP 3



- Center one of the lock caps **(F)** over any hole on the side of the connecting rail.
- Using a small rubber mallet or (a block of wood and a small hammer), tap on the locking cap until it is secured over the pin sticking through the side of the connecting rail.
- Repeat this procedure for each of the additional openings. You will only need to use a total of (4) lock caps.

## STEP 4

- One step **(AC 30163)** should already be inside the pool and weighted in place.
- Place second assembled step **(AC 30163)** on outside of the pool, lined up with the step placed inside the pool during step installation. Make sure step is on level ground.
- Slide the assembled crossover down over the upper handrail posts of the steps until it is resting on the pool top rail. It may be necessary to lubricate posts prior to installing crossover.



**CAUTION** DO NOT attempt to stand on crossover until bridge is fully assembled.

## STEP 5



- The crossover must be screwed into the handrail posts using (16) #10 x 1-1/4" screws (G). Each of the locations where a screw must be drilled into handrail posts is pre-marked. There are eight per side.

## STEP 6



**NOTE** If you are installing PARADISE ISLE BRIDGE (with gate) you should install handrails on **INSIDE** step only at this time. Please refer to gate (AC 30988) instructions for further details.

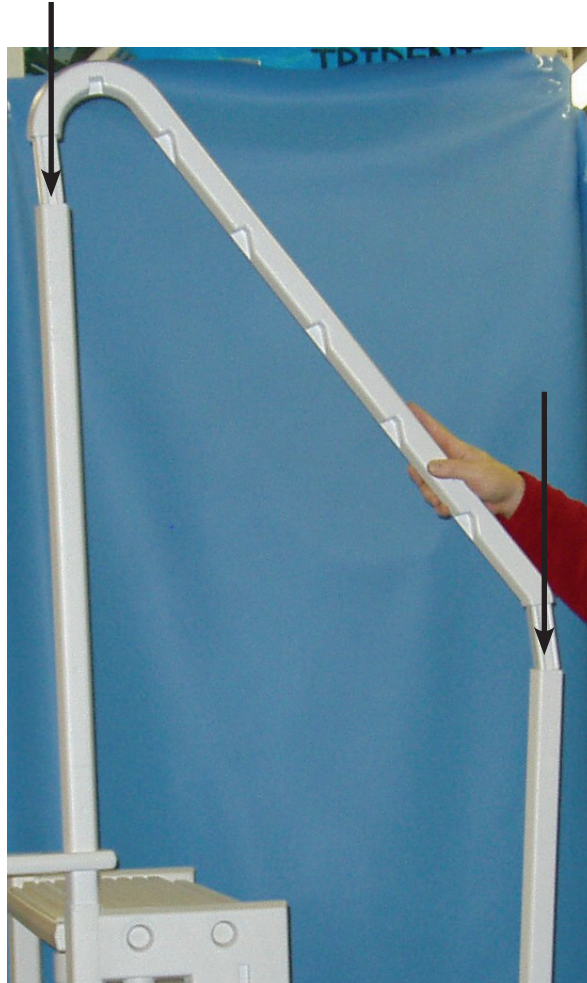

- Lubricate the end of the handrails (packed with **AC 30163**) with liquid soap or lubricant and slip the ends of the handrails into the open ends of the posts on the inside and outside steps.
- Push handrails down until they are fully seated on posts.
- Secure in place using (1) #10 x 1-1/4" screw (**G**) per post (2 on each side).

## STEP 7



- Align one of the triple pickets (**E**) with the notches at the top of the handrail of the OUTSIDE step. The triple picket will line up with the openings in the handrail on the top step.
- The double picket (**D**) will fit on the second step down (shown).
- The single picket (**C**) will be attached to the handrail on the third step down.
- Fasten the pickets in place one at a time at the top and bottom using the #10 x 3/4" screws (**H**).

## STEP 8

Crossover installation is completed at this time. If you are installing the **PARADISE ISLE BRIDGE SYSTEM** (with gate) please refer to gate carton (AC 30988) for gate assembly instructions and completing installation of your bridge system.

## SAFETY INFORMATION

- When lifting heavy or awkward loads, it is suggested that two people lift to avoid injury.
- **DO NOT** use the pool entry system for any purpose other than that for which it is intended.
- Maximum weight on steps should **NOT** exceed 350 lbs.



**WARNING** Exceeding the recommended weight limit may cause the step to fail and may result in injury.

## MAINTENANCE

- Step/ladder/bridges must be removed for winter, failure to do so can cause the step to crack.
- When removing step/ladder/bridges for winter, it is recommended that you spray down step with hose water to rinse off any chemical residual prior to storing.
- When storing step/ladder/bridges for winter, it should be protected from the elements and stored either in a shed or garage, or covered with a tarp.



**DANGER**

**WARNING**

To prevent  
Entrapment or  
Drowning,  
**DO NOT SWIM**  
through, behind  
or around the  
ladder

**DANGER**

**SAFETY  
NOTICE  
IMPORTANT**

**WARNING**

This ladder is  
designed and  
manufactured for  
**Aboveground,  
Semi-Inground  
Flat Bottom  
Pools**  
48", 52" and 54"  
in wall height  
and pool decks  
48", 52" and 54"  
in height

**WARNING**

**DANGER**

Entry/Exit of  
Pool,  
**Face the  
Ladder at  
all times**

**DANGER**

**PLEASE  
READ  
BEFORE  
USING  
THIS  
LADDER**

**DANGER**

When  
**NOT IN USE**  
remove or  
secure ladder  
when the pool  
is not  
Occupied

**DANGER**