

B4-FILTER PRE-FILTER SKIMMER SYSTEM

MODEL BS 202PSN

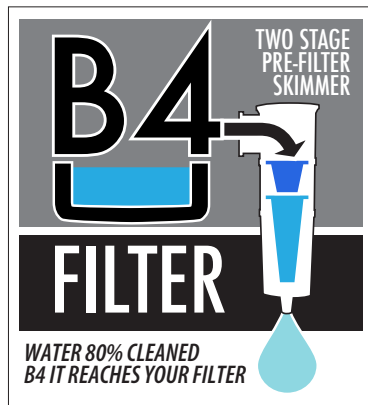

*Congratulations on purchasing a
Pro-Series Automatic Skimmer & Pre-Filter System*

PRO SERIES AUTOMATIC SKIMMER & PRE-FILTER SYSTEM MODEL BS 202PSN



We are confident that you too will discover why Blue Torrent products are unparalleled industry-wide. Our decision to produce the finest quality products has allowed us to gain the respect of the entire pool industry.

This skimmer comes with an exclusive Hydromatic Pre-Filter Bag which is designed to increase the length of your filter cycles. The Blue Torrent replacement skimmer is carefully designed to ensure a perfect fit on all aboveground pools manufactured with the standard square cutout or a widemouth cutout (adapter available at an additional charge).



The Hydromatic Pre-Filter Bag provides many benefits to you as the consumer. Each bag filters out particles as small as 500 microns. The benefits include:

- Extended filter cycles
- Bag holds 5 times more debris than a standard basket
- Basket does not fill up quickly so vacuuming is easier
- Flow of larger horsepower pump is not restricted with bag
- Bag is reusable



- Your Blue Torrent 202PSN is equipped with an extra large debris basket. The large capacity not only holds more debris than standard skimmer baskets it allows for a large reservoir of water in the skimmer.
- This eliminates a lot of strain on your filter pump and increases its efficiency. The extra large basket allows for the use of micro screen pre-filters. By installing micro-screens into your skimmer basket you can eliminate up to 50% of filter maintenance by trapping the fine debris BEFORE it gets into your filter.

BS 202PSN AUTOMATIC SKIMMER & PRE FILTER SYSTEM PARTS

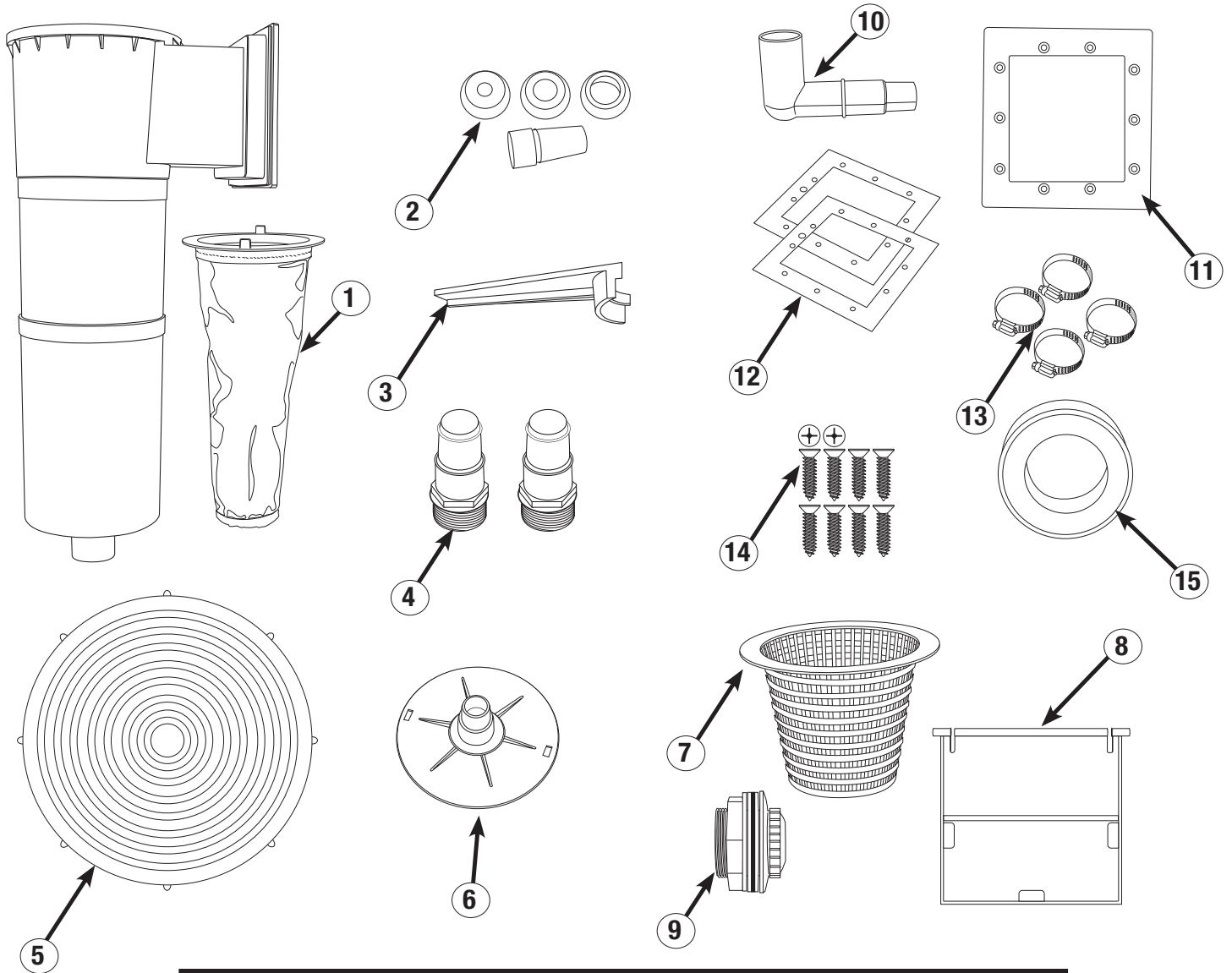

PART #	MODEL #	DESCRIPTION	QTY
1	BS 26298	Pre Filter Bag	1
2	BS 26905	Eyeball Kit	1
3	BS 26484	Stand Off	1
4	BS 40061BLK	Hose Fittings	2
5	BS 25673	Top Cover	1
6	BS 08370	Vacuum Plate	1
7	AC 93378	Strainer Basket	1
8	BS 25623	Skimmer Weir	1
9	BS 20133	Return Fitting	1
10	BS 74470	Vacuum Elbow	1
11	BS 25453	Standard Face Plate	2
12	JT 37435	Skimmer Gaskets	2
13	LOM 150	Stainless Steel Clamps	4
14	JT 37575	Skimmer Screws	8
15	JT 37443	Teflon Tape	1

INSTALLING YOUR NEW SKIMMER

STEP 1

If this is a new pool, fill pool per manufacturer's instructions to 2" below the return opening prior to installing your filter.

If this is an existing pool, drop water level to 2" below return opening before proceeding to step 2.

STEP 2

Line up skimmer gasket (JT 37435) with holes on the outside of the pool and line up second skimmer gasket even with outside gasket (so holes line up) on inside of pool so that there is one skimmer gasket against the liner on the inside and the second is against the outside wall (see figures 1 & 2).

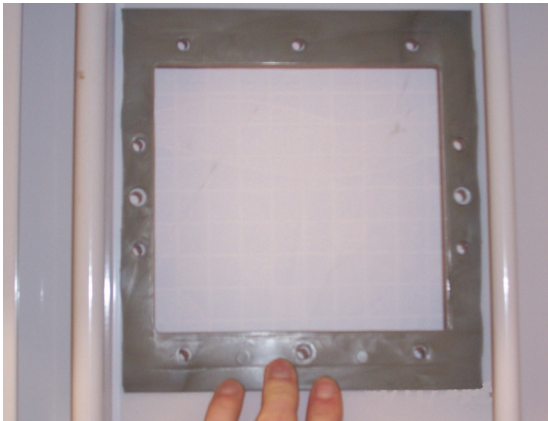

Figure 1 - Lining up gasket on outside

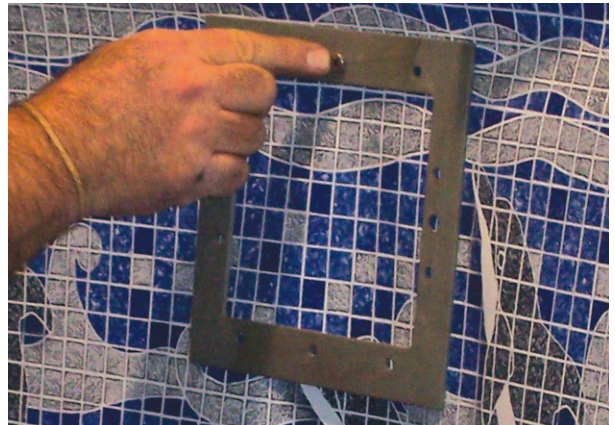

Figure 2 - Lining up gasket on inside

STEP 3

Line up skimmer plate (BS 25453) against the gasket on the inside of pool with all holes matching up to those on the skimmer gasket (see figure 3).

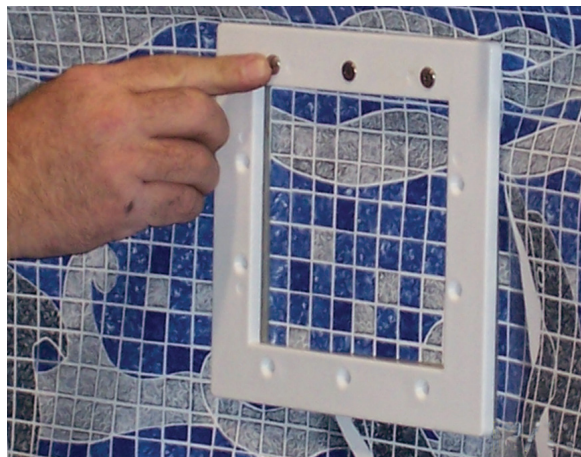

Figure 3 - Lining up skimmer plate

STEP 4

Line up skimmer body with holes on gasket from the outside of the pool (see figure 4) and insert skimmer screws through plate and into all openings on skimmer body (see figure 5).



Figure 4 - Lining up skimmer body with gasket

STEP 5

Using a phillips head screwdriver turn each screw several turns in order to ensure that all screws line up with the holes in the skimmer body (see figure 5).

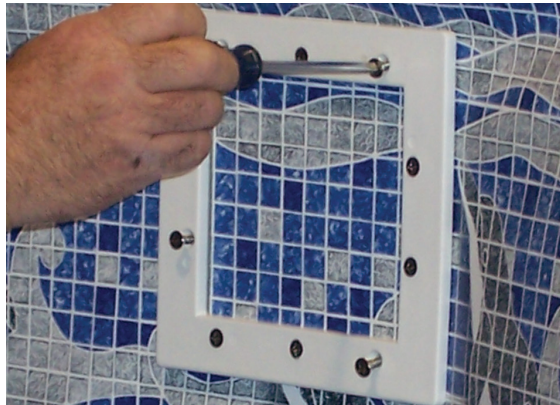

Figure 5 - Tightening screws on skimmer plate

STEP 6

If all screws are lined up correctly in step 5, you should now hand tighten each screw until snug without over tightening

STEP 7

Once all screws are hand tight, the skimmer plate should have 10 screws and look as shown in figure 6.

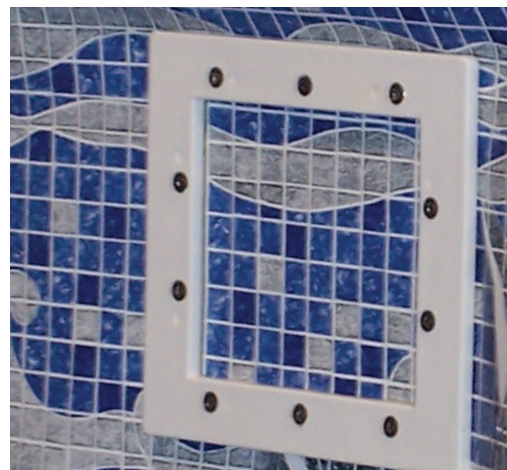

Figure 6 - Skimmer plate with screws installed

STEP 8

Use Teflon tape (BS 35858) to cover all threads on hose fitting (BS 26646BLK) and screw hose fitting with threads facing upwards into skimmer body bottom opening (see figure 7).



Figure 7 - Applying Teflon tape to hose adaptor

STEP 9

Cut vinyl covering skimmer opening with razor blade carefully as close as possible to edges of skimmer opening (see figures 8 & 9).

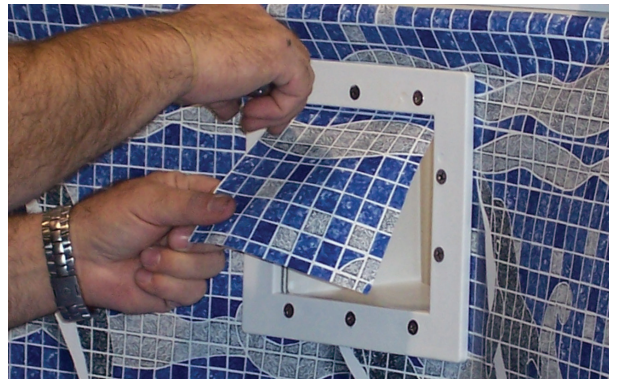

Figure 8 - Cutting vinyl out of opening

STEP 10

Place Pre-Filter Bag (BS 26298) into skimmer body from outside of pool. There is no need to install standard basket while filter bag is inside skimmer (see figure 10).

STEP 11

Install Skimmer Basket into Pre-Filter Bag. Align the tabs of the Pre-Filter with the notches in the basket.



Figure 9 - Final skimmer opening

STEP 12

Install top cover (BS 25763) on round opening on top of skimmer (see figure 11).



Figure 10 - Pre-Filter Bag installed in skimmer body



Figure 11 - Installing top cover, skimmer fully installed

STEP 13

Attach a 1-1/4" or 1-1/2" hose onto fitting installed in step 8 and clamp into place using one stainless steel clamp (see figure 13). Attach the loose end of the hose to fitting on intake of pump (typically opening on front of pump) and clamp into place (see figure 12). If hose seems too snug to fit over hose fitting place end of hose in hot water for 5 minutes then install on fitting.



Figure 12 - Attaching hose to pump

STEP 14

Install skimmer weir (BS 25623) into skimmer from inside of pool by placing tabs into notches on skimmer even with faceplate (see figures 14 A and 14 B).



Figure 13 - Attaching hose to skimmer



Figure 14 A - View from inside of skimmer

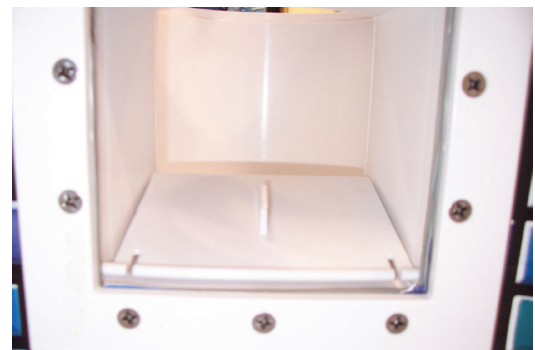

Figure 14 B - View from inside pool

STEP 15

Install skimmer standoff (BS 26484) with curved side facing skimmer body and with the tape side closest to the ground. Remove backing of double-sided tape and stick on top of center lip of skimmer. The small end should lean against the pool to prevent buckling of pool wall (see figure 15).



Figure 15 - Standoff installed, lip of standoff sits on lip of skimmer

INSTALLATION OF RETURN FITTING

STEP 1

Unscrew all pieces of return fitting so that you have six pieces separated into:

- 2 rubber gaskets
- 1 cork gasket
- 1 ball seat
- 1 locknut
- 1 return (circular ring with threaded back)

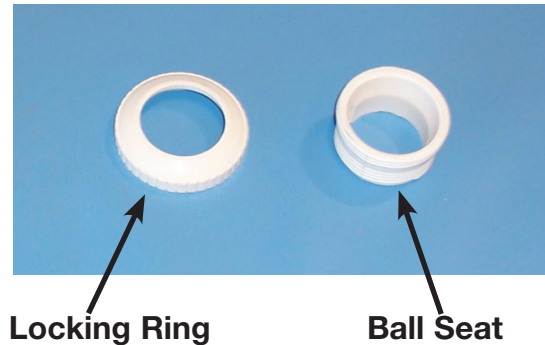

STEP 2

Push liner against wall from the inside and make a small "X" in the center of the return using a razor blade (see figures 1 & 2).



Figure 1 - Liner against wall



Figure 2 - Liner opening cut

STEP 3

Place one rubber gasket on the return over the threads (see figure 3).



Figure 3 - Inside gasket on return

STEP 4

Push return from inside of the pool through the circle shaped opening that you made small "X" in so that return sticks out through the wall (see figure 4).



Figure 4 -Return pushed through wall

STEP 5

Place second rubber gasket over threads so it is touching the outside part of the wall. Place cork gasket on in the same fashion in front of the rubber gasket (see figure 5).



Figure 5 - How to install rubber & cork gasket outside

STEP 6

Take the locknut (see figure 6) and screw it onto the threads with the flat side facing the pool (see figure 7).



Figure 6 - Locknut

STEP 7

Screw the ball seat (small round threaded piece) inside the threads of the return (see figure 8), place eyeball inside and secure with locking ring.

NOTE: If you have an oval pool, it is suggested that you use 1" eyeball with blue directional. To eliminate harmful back pressure from a strong pump, use 1" eyeball. See figure 9 for completed return.



Figure 7 - Direction locknut should face

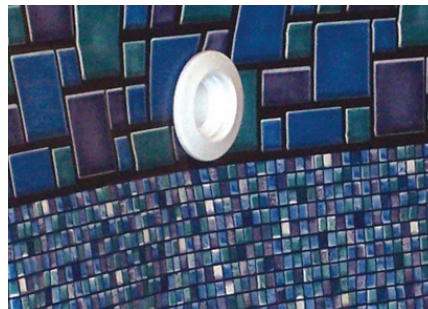

Figure 8 - Opening for ball seat to be screwed into

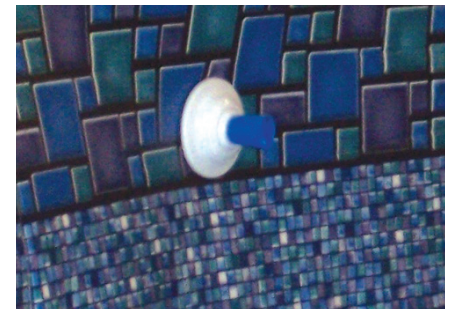

Figure 9 - Completed return inside pool

STEP 8

Take hose fitting (BS 26646BLK) and cover threads with Teflon tape (see figure 10) and screw into threaded opening on outside of return (see figure 11). Attach 1-1/4" or 1-1/2" filter hose with clamp (BS 35815) and attach loose end to discharge of pump (typically top opening) with final hose clamp.



Figure 10 - Teflon tape hose adaptor



Figure 11 - Return with outside return fitting

VACUUMING PROCEDURE

When it is necessary to vacuum your pool, please follow the guidelines listed below in order to ensure proper suction and successful vacuuming.

1. Make sure that you have a vacuum head with handle, telescopic pole and vacuum hose that is at least 6' longer than your pool (all sold separately).
NOTE: If your pool is 18' round, your hose should be at least 24' long
NOTE: If your pool is 12' x 24' oval, your hose should be at least 30' long
2. You will need your Pre-Filter bag, skimmer basket, vacuum plate and elbow to hook up your vacuum.
3. Make sure that your Pre-Filter bag is empty and clean inside the skimmer body. Using the Pre-Filter bag versus standard basket will allow skimmer to catch more dirt and debris. The large capacity of debris the pre-filter can hold will prolong the life of your Filter Element. More dirt and debris is caught in the large cap than in a standard basket and it is easier to clean a Pre-Filter than a Filter.
4. Attach swivel cuff of vacuum hose onto vacuum head. Attach telescopic pole to vacuum handle and place into bottom of pool.
5. Take the loose end of the hose and bring it to the return underneath the water level with the filter running. The vacuum head will float up as air is forced from the hose. Once the vacuum head has stopped moving and the air bubbles have stopped, all the air is out. This procedure is called priming the hose.
6. Remove top cover of skimmer. If not already in place, install Pre-Filter bag and skimmer basket. Place the vacuum plate over both the Pre-Filter bag and skimmer basket. The notches in the vacuum plate will align with the tabs from the Pre-Filter bag that protrude thru the skimmer basket.

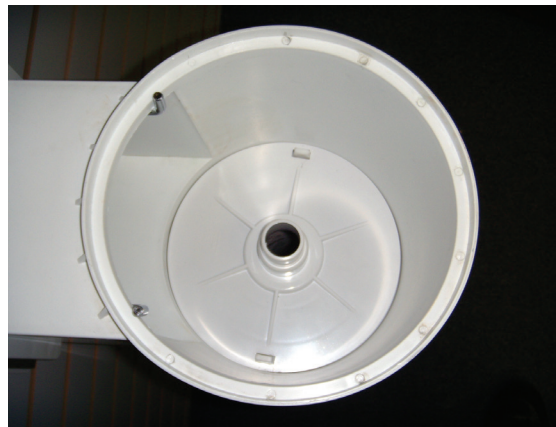
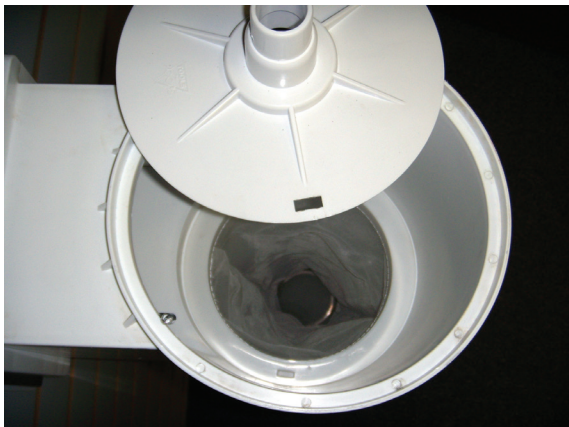

Figure 1 - Vacuum Plate going onto Pre-Filter bag

7. Place vacuum elbow with fat side over top of vacuum plate and make sure that longer side is pointing into the pool (see figure 2).



Facing into skimmer opening
towards pool

Figure 2 - Vacuum Plate & Elbow on basket

8. Move primed vacuum hose under water level from the return to the skimmer as the filter continues to run. DO NOT bring hose over water level as hose will fill with air.
9. Push weir door down flat into pool so that it does not interfere with vacuuming (see figure 3).



**Figure 3 -
Positioning weir for
vacuuming**

10. Place hose onto vacuum elbow through skimmer opening keeping hose underwater. If you were to look through the outside of the skimmer, it should look as figure 4 does.



**Figure 4 - Inside look
at elbow on plate
and attached hose**

11. You are now ready to vacuum. Remember to keep vacuum underneath water line at all times. Failure to do so will result in the need to re-prime the hose and start over. Breaking the water level allows air to enter the hose and affects your suction.
12. After vacuuming you should remove and clean your pre-filter bag to prevent sluggish return flow.

OPTIONAL BONDING PLATES

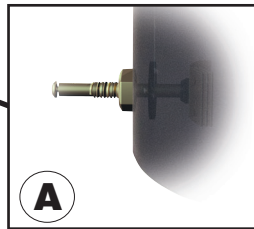

A) The bonding post is installed in the bonding port of the skimmer housing (pic A)

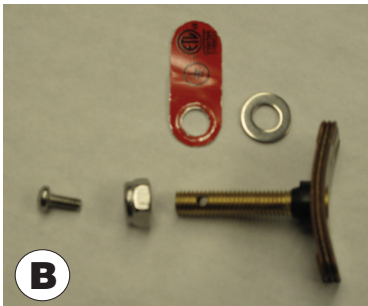

B) Disassemble bonding post. Remove bonding screw, nut, plate and washer from the bonding post (pic B)



C) Insert the bonding post into the bonding port from the inside of the skimmer housing (pic C)

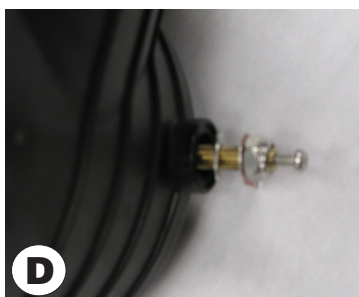

D) Reinstall the washer, plate nut and screw in that order onto the bonding post (pic D)

- Tighten the nut firmly onto the bonding post
- To ground the water in the pool using the Bonding plate you **MUST** use an independent copper ground wire. **DO NOT USE THE SAME GROUND CONNECTED TO THE ELECTRIC MOTOR.**

BLUE TORRENT B4U-SKIMMER SYSTEM

Model: BS 202PSN ONE YEAR LIMITED WARRANTY

One year limited warranty from date of purchase.

The **BS 202PSN** Skimmer System is guaranteed to be free of manufacturers defects in material and workmanship under normal use in accordance with the proper installation and operation manual.

This Warranty does not cover the following: Damage due to freezing caused by or related to improper drainage, winterization, or storage. Damage or failures arising from use of the product which does not comply with the instructions provided in this manual.

This Warranty is in lieu of all other express warranties. Replacement of defective products as provided under this warranty is your exclusive remedy. The manufacturer will not be liable in contract or tort for any direct, consequential, special, or incidental loss or damage arising out of the use or inability to use this product.

WARRANTY COVERAGE

1st Year — 100% coverage against any manufacturers defects.

ALL WARRANTY CLAIMS MUST BE HANDLED DIRECTLY WITH THE DEALER WHERE THE PRODUCT WAS PURCHASED. A SALES RECEIPT IS REQUIRED TO VERIFY PROOF OF PURCHASE